

Fiscal year 2018 Pre-release of power generation data

12 February 2019

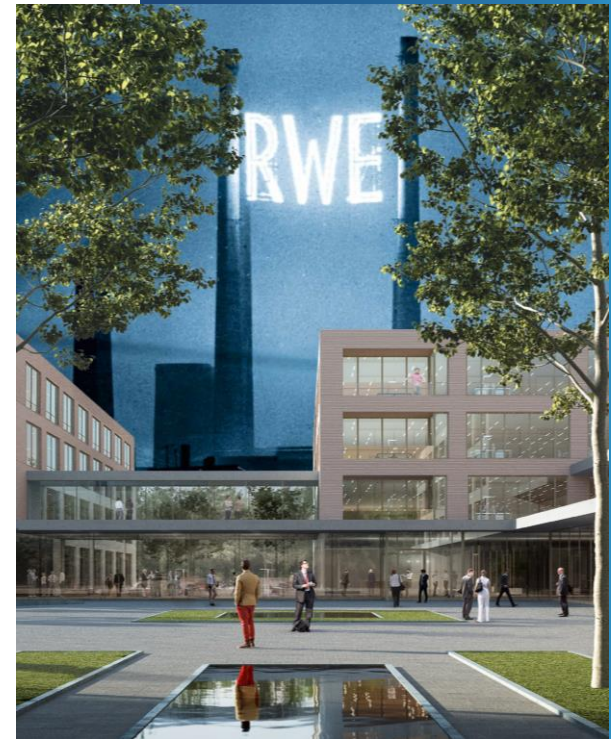

Powering. Reliable. Future.

RWE

RWE's electricity generation January - December (Q1 - Q4)

PREVIEW

Billion kWh	Lignite		Hard coal		Gas		Nuclear		Renewables		Pumped storage, other		Total	
	2018	2017	2018	2017	2018	2017	2018	2017	2018	2017	2018	2017	2018	2017
Lignite & Nuclear	67,2	74,2	-	-	-	-	21,8	30,3	-	-	0,2	0,7	89,2	105,2
of which														
Germany	66,0	69,5	-	-	-	-	20,8	29,4	-	-	0,2	0,7	87,0	99,6
Netherlands	-	-	-	-	-	-	1,0	0,9	-	-	-	-	1,0	0,9
Hungary	1,2	4,7	-	-	-	-	-	-	-	-	-	-	1,2	4,7
European Power	-	-	27,4	29,3	47,2	52,9	-	-	1,1	1,1	2,3	2,4	78,0	85,7
of which														
Germany ¹	-	-	13,0	13,3	5,5	7,4	-	-	0,7	0,7	2,3	2,4	21,5	23,8
United Kingdom	-	-	0,5	2,6	33,2	32,4	-	-	0,4	0,4	-	-	34,1	35,4
Netherlands/Belgium	-	-	13,9	13,4	5,5	9,3	-	-	-	-	-	-	19,4	22,7
Turkey	-	-	-	-	3,0	3,8	-	-	-	-	-	-	3,0	3,8
innogy-continuing operations	-	-	-	-	-	-	-	-	8,8	9,3	-	-	8,8	9,3
RWE Group	67,2	74,2	27,4	29,3	47,2	52,9	21,8	30,3	9,9	10,4	2,5	3,1	176,0	200,2

¹ Including electricity from power plants not owned by RWE that we can deploy at our discretion on the basis of long-term agreements. In fiscal year 2018, this amounted to 5.0 billion kWh (fiscal year 2017: 6.3 billion kWh) of which 2.3 billion kWh from hard coal (2017: 3.5 billion kWh).

- > Lower lignite power generation due to lignite reserve (Frimmersdorf P (284 MW) and Q (278 MW) since Q4 17; Niederaußem E (295 MW) and F (299 MW) since Q4 18
- > Hungarian lignite power generator Mátra reported under 'assets held for sale' since Q2 2017; disposal closed in Q1 2018
- > Hard coal: Closure of German Voerde A/B (1,390 MW) as of 1 April 2017; UK Aberthaw (1,560 MW) changed to primarily capacity market operation in April 2017
- > Gas Germany: margin related lower electricity generation
- > Gas Netherlands: Moerdijk 1 (339 MW) power plant mothballed since January 2018
- > Lower nuclear generation due to closure of Gundremmingen B (1,284 MW) as of 31 December 2017

RWE's electricity generation October - December (Q4)

PREVIEW

Billion kWh	Lignite		Hard coal		Gas		Nuclear		Renewables		Pumped storage, other		Total	
	2018	2017	2018	2017	2018	2017	2018	2017	2018	2017	2018	2017	2018	2017
Lignite & Nuclear	14,8	17,9	-	-	-	-	6,1	7,9	-	-	0,1	0,2	21,0	26,0
of which														
Germany	14,8	16,5	-	-	-	-	5,8	7,6	-	-	0,1	0,2	20,7	24,3
Netherlands	-	-	-	-	-	-	0,3	0,3	-	-	-	-	0,3	0,3
Hungary	-	1,4	-	-	-	-	-	-	-	-	-	-	-	1,4
European Power	-	-	7,1	6,0	13,1	13,3	-	-	0,2	0,3	0,5	0,7	20,9	20,3
of which														
Germany ¹	-	-	3,2	2,9	1,9	1,8	-	-	0,1	0,2	0,5	0,7	5,7	5,6
United Kingdom	-	-	0,1	-	9,0	8,6	-	-	0,1	0,1	-	-	9,2	8,7
Netherlands/Belgium	-	-	3,8	3,1	1,3	2,4	-	-	-	-	-	-	5,1	5,5
Turkey	-	-	-	-	0,9	0,5	-	-	-	-	-	-	0,9	0,5
innogy-continuing operations	-	-	-	-	-	-	-	-	2,5	3,1	-	-	2,5	3,1
RWE Group	14,8	17,9	7,1	6,0	13,1	13,3	6,1	7,9	2,7	3,4	0,6	0,9	44,4	49,4

¹ Including electricity from power plants not owned by RWE that we can deploy at our discretion on the basis of long-term agreements. In Q4 2018, this amounted to 1.2 billion kWh (Q4 2017: 1.4 billion kWh) of which 0.6 billion kWh from hard coal (Q4 2017: 0.6 billion kWh).

- > Lower lignite power generation due to lignite reserve (Niederaußem E (295 MW) and F (299 MW) since Q4 2018
- > Hungarian lignite power generator Mátra reported under 'assets held for sale' since Q2 2017; disposal closed in Q1 2018
- > Lower lignite power generation due to unplanned outages in Q4 2018
- > Gas Netherlands: Moerdijk 1 (339 MW) power plant mothballed since January 2018
- > Lower nuclear generation due to closure of Gundremmingen B (1,284 MW) as of 31 December 2017