

AREA-1

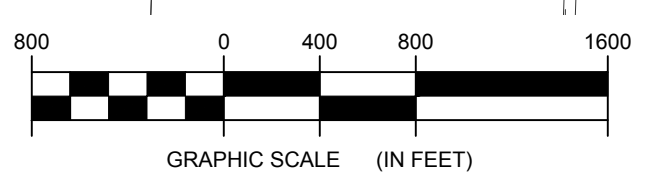
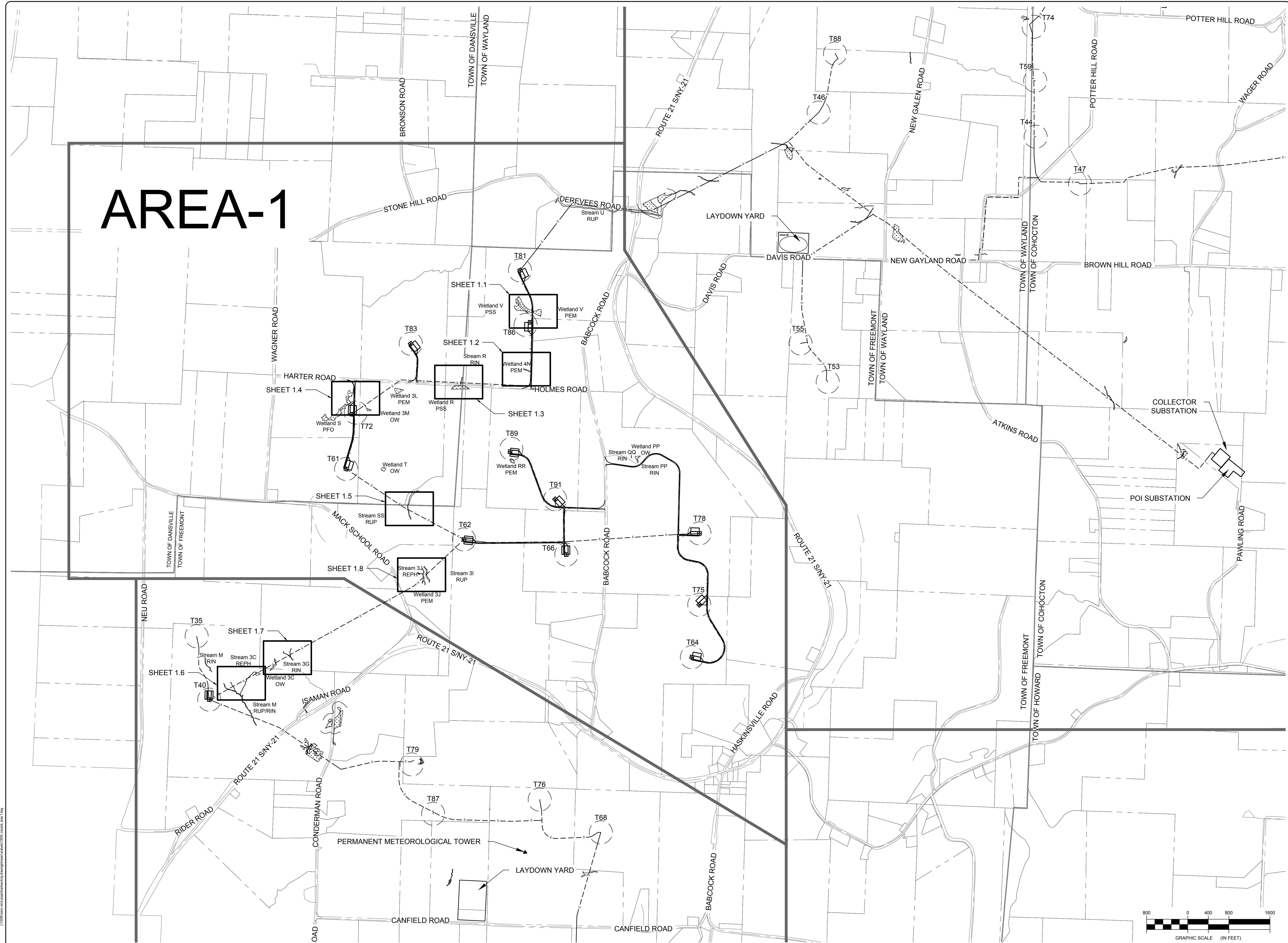

©2018 Environmental Design & Research, LLC
 License: Professional Engineer
 This drawing is prepared under the supervision of a Professional Engineer. The Professional Engineer's name and license number are indicated on this drawing. This drawing is not to be used for any other purpose without the written consent of Environmental Design & Research, LLC. No part of this drawing may be reproduced or transmitted in any form or by any means, electronic, mechanical, photocopying, recording, or by any information storage and retrieval system, without the prior written permission of Environmental Design & Research, LLC. The user of this drawing shall be deemed to have accepted the terms and conditions of this license.

NO.	DATE	REVISION

PROJECT TITLE: BARON WINDS PROJECT
TOWNS OF COHOCTON, DANVILLE, FREMONT, AND WAYLAND -
STEBEN COUNTY, NEW YORK
CLIENT: EVERPOWER WIND HOLDINGS
DRAWING TITLE: AREA 1 WETLAND/STREAM IMPACT OVERVIEW

DATE: NOVEMBER 17, 2017
SCALE: SEE SCALE BAR
EDR JOB: 13039
DRAWN BY: AW, JT, TS, PR
FILE NAME: 13039_Impacts_Area 1.dwg
DRAWING NUMBER: OVERVIEW 1

J:\13039 Baron Winds\p\graphics\working\Impacts\Area 1.dwg

SHEET 1.1

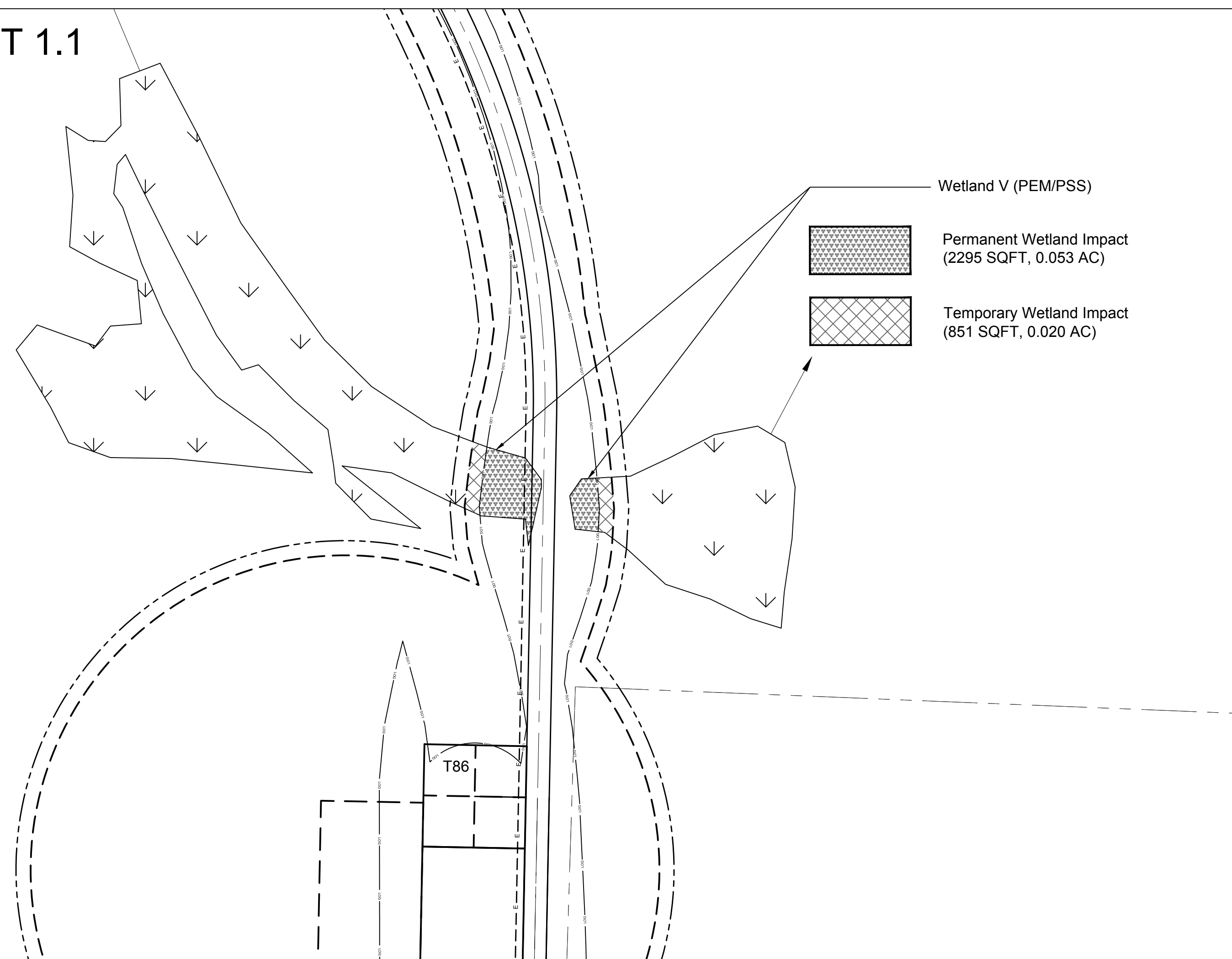

SHEET 1.2

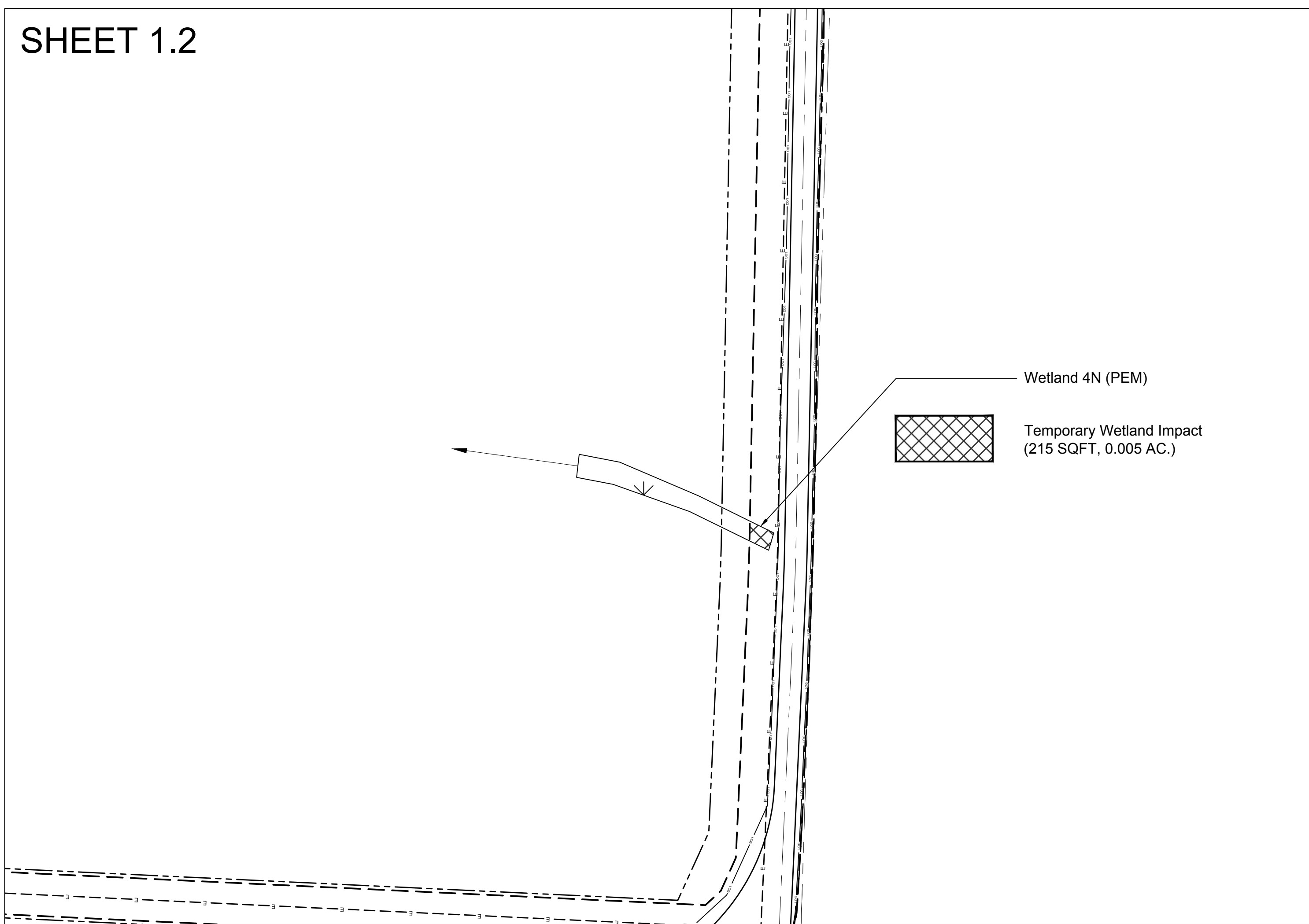

SHEET 1.3

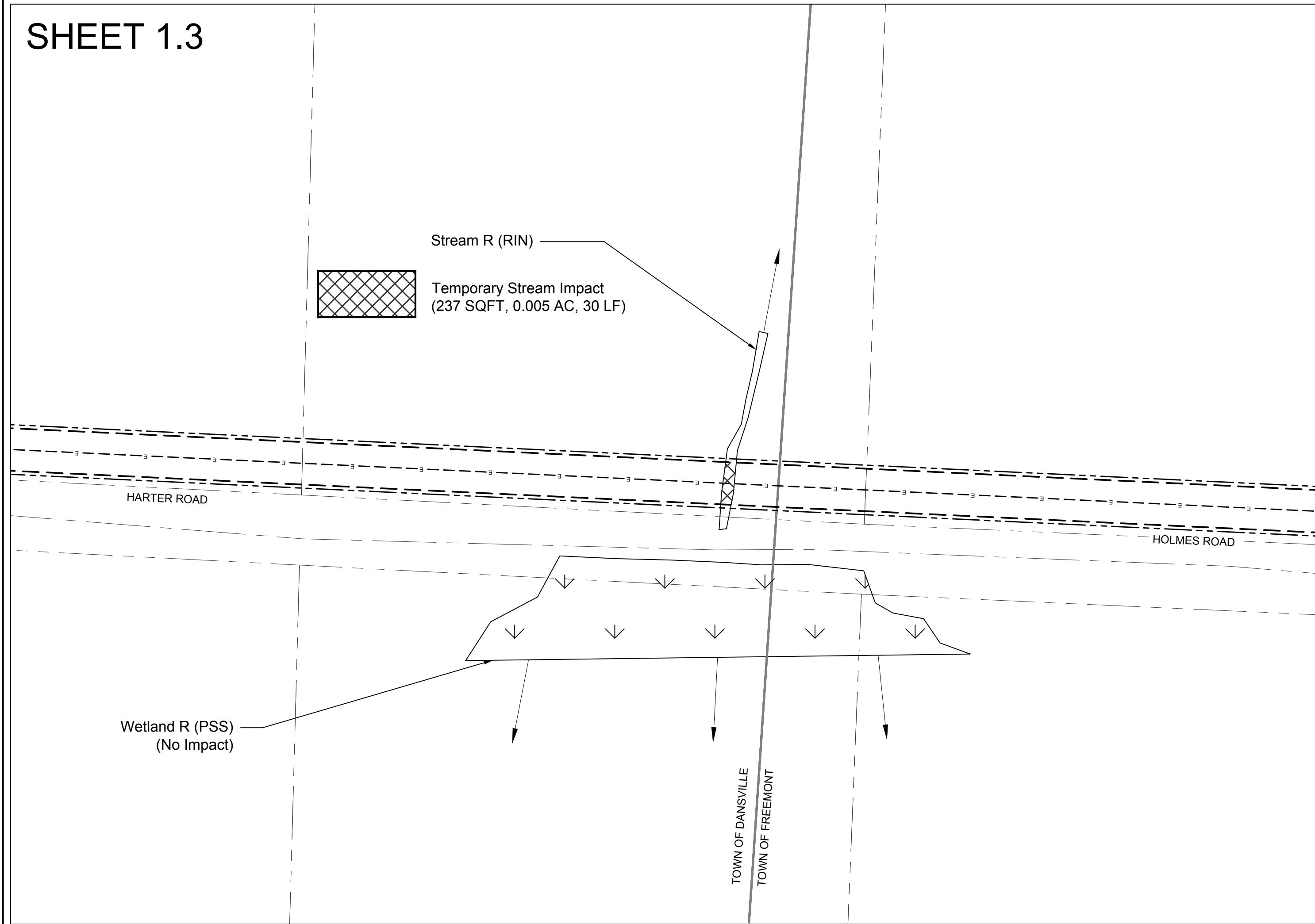

SHEET 1.4

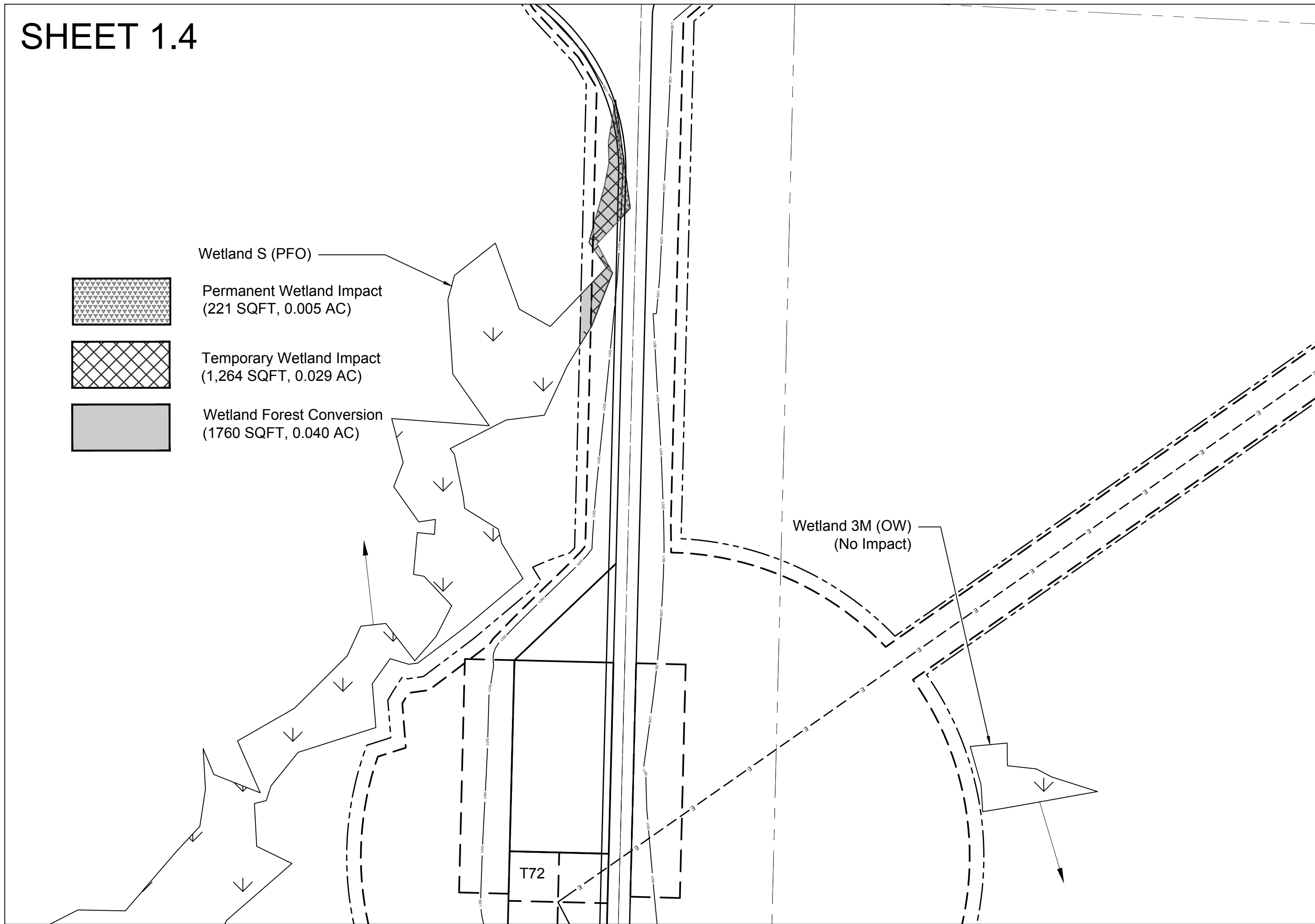

LEGEND
 --- Underground Collection Line --- Limits of Grading --- Limits of Vegetation Clearing
 --- Overhead Collection Line --- Limits of Soil Disturbance --- Wetland/Stream Continues

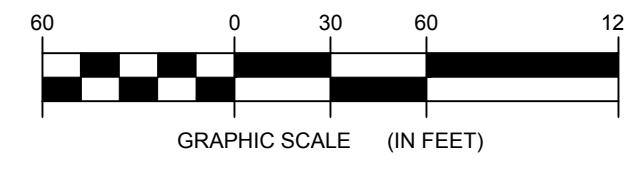

Environmental Design & Research,
 Landscape Architecture, Engineering
 & Environmental Services, D.P.C.

217 Montgomery Street, Suite 1000
 Syracuse, New York 13202
 P. 315.471.0688



everpower

©2019 Environmental Design & Research, Landscape Architecture, Engineering & Environmental Services, D.P.C. The following is prepared for the use of the client and is not to be used for any other purpose without the written consent of the firm. This is a preliminary drawing and is subject to change without notice. The client acknowledges that the use of this drawing for any other purpose is at their own risk. The firm and its representatives shall not be held liable for any errors or omissions in this drawing. The client shall be responsible for obtaining all necessary permits and approvals from the appropriate authorities. The client shall be responsible for obtaining all necessary insurance and bonding. The client shall be responsible for obtaining all necessary approvals from the appropriate authorities. The client shall be responsible for obtaining all necessary approvals from the appropriate authorities.

DRAWING REVISIONS	
NO.	REVISION

PROJECT TITLE: BARON WINDS PROJECT
TOWNS OF COHOCTON, DANVILLE, FREEMONT, AND WAYLAND -
PROJECT LOCATION: STEUBEN COUNTY, NEW YORK
CLIENT: EVERPOWER WIND HOLDINGS
DRAWING TITLE: AREA 1 WETLAND/STREAM IMPACT DRAWINGS

DATE: **NOVEMBER 17, 2017**
 SCALE: **SEE SCALE BAR**
 EDR JOB#: **13039**
 DRAWN BY: **AW, JT, TS, PR**
 FILE NAME: **13039_Impacts_Area 1.dwg**
 DRAWING NUMBER: **1.1-1.4**

1/13/2019 10:00 AM and geotechnical engineering analysis 13039_Impacts_Area 1.dwg

