

1/13/2009 Baron Winds Project/Impacts/Impacts Area 4.dwg

AREA-6

AREA-4

AREA-5

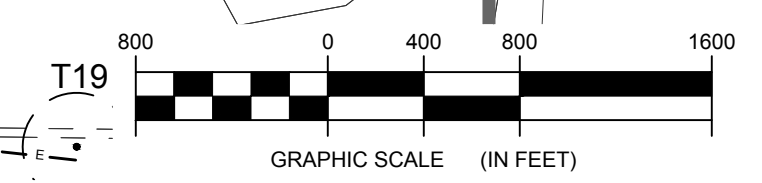
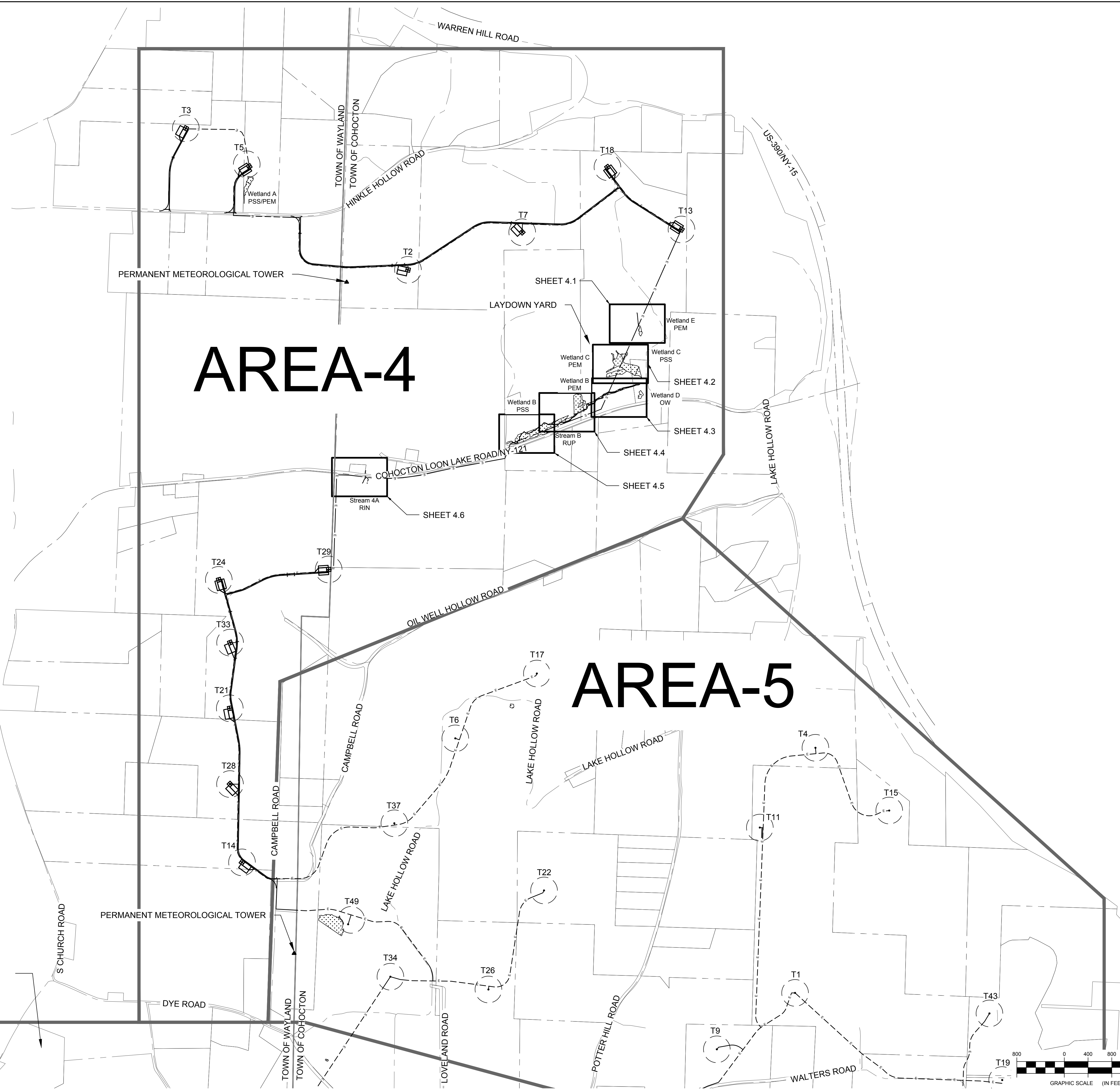

Environmental Design & Research,
Landscape Architecture, Engineering
& Environmental Services, D.P.C.

217 Montgomery Street, Suite 1000
Syracuse, New York 13202
P. 315.471.0688



everpower

©2009 Environmental Design & Research, L.L.C. All rights reserved. This drawing is prepared for the use of the client and is not to be used for any other purpose without the written consent of Environmental Design & Research, L.L.C. The client is responsible for obtaining all necessary permits and approvals from the appropriate authorities. The client is also responsible for obtaining all necessary insurance and bonding. The client is also responsible for obtaining all necessary approvals from the appropriate authorities. The client is also responsible for obtaining all necessary approvals from the appropriate authorities.

DRAWING REVISIONS	
NO.	DATE

PROJECT TITLE: BARON WINDS PROJECT
TOWNS OF COHOCTON, DANVILLE, FRENCHTOWN, AND WAYLAND,
ST. LOUIS COUNTY, NEW YORK
CLIENT: EVERPOWER WIND HOLDINGS
DRAWING TITLE: AREA 4 WETLAND/STREAM IMPACT OVERVIEW

DATE: **NOVEMBER 17, 2017**
SCALE: **1"=800'**
JOB: **13039**
DRAWN BY: **AW, JT, TS, PR**
FILE NAME: **13039_Impacts_Area 4.dwg**
DRAWING NUMBER: **OVERVIEW 4**

SHEET 4.1

Notes:
 1. No impacts proposed to Wetland E (PEM) and Stream E (RIN). Crossing method will be matt and span, span and drive around, or avoid.

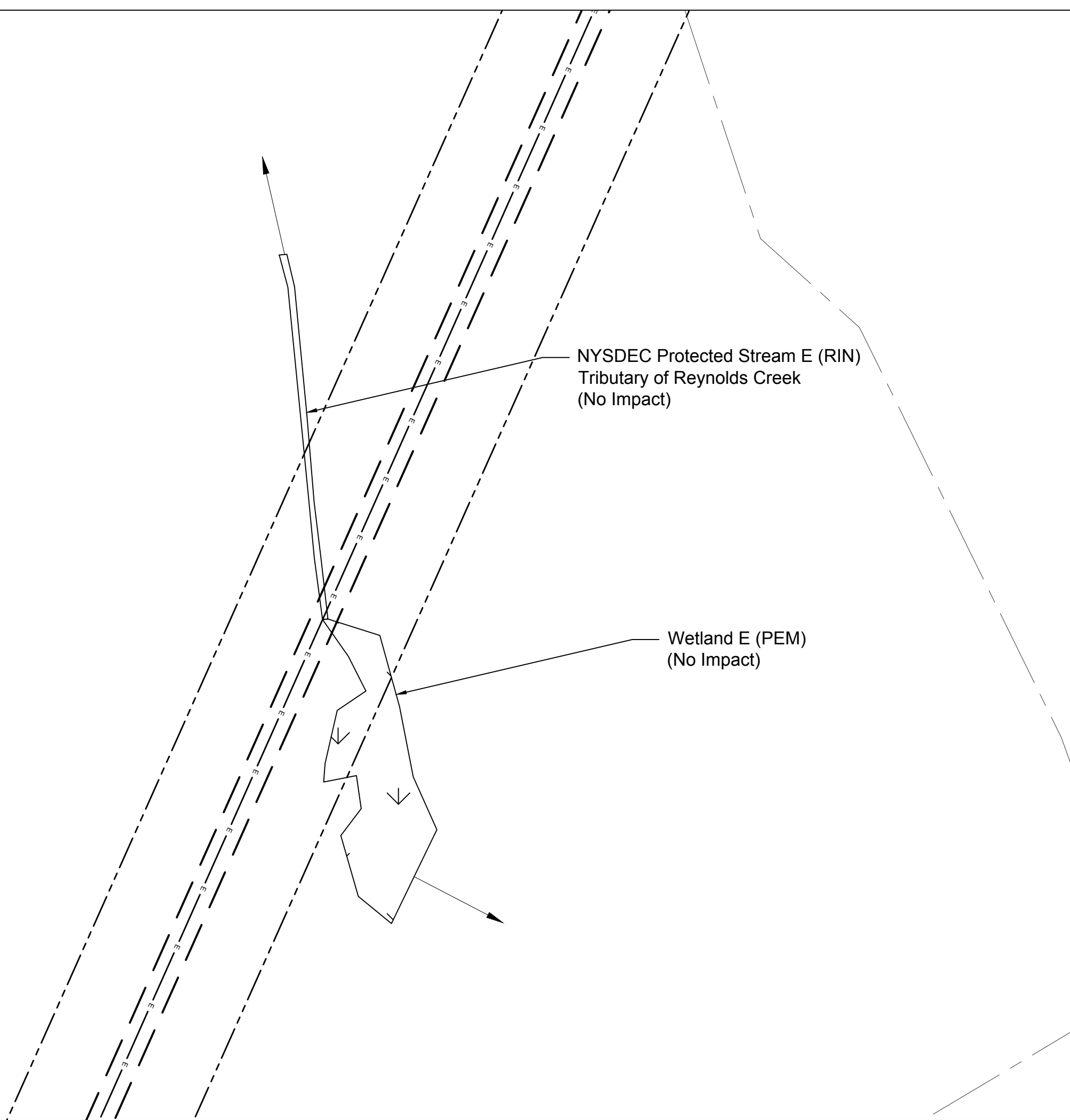

SHEET 4.2

Notes:
 1. No impacts proposed to Wetland C (PEM/PSS). Crossing method will be matt and span, span and drive around, or avoid.

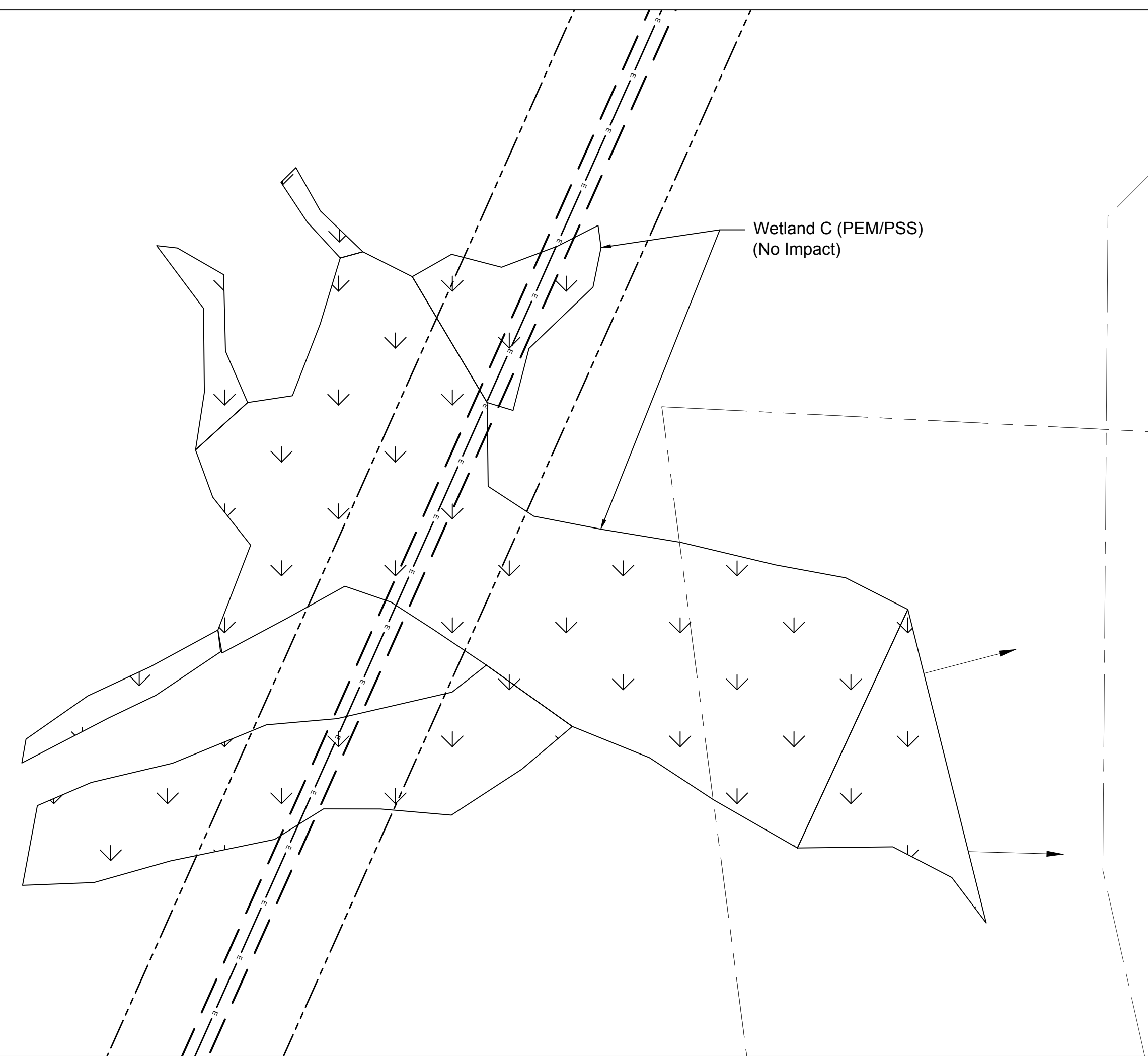

SHEET 4.3

Notes:
 1. No impacts proposed to Wetland B (PEM) and Stream B (RUP). Crossing method will be matt and span, span and drive around, or avoid.

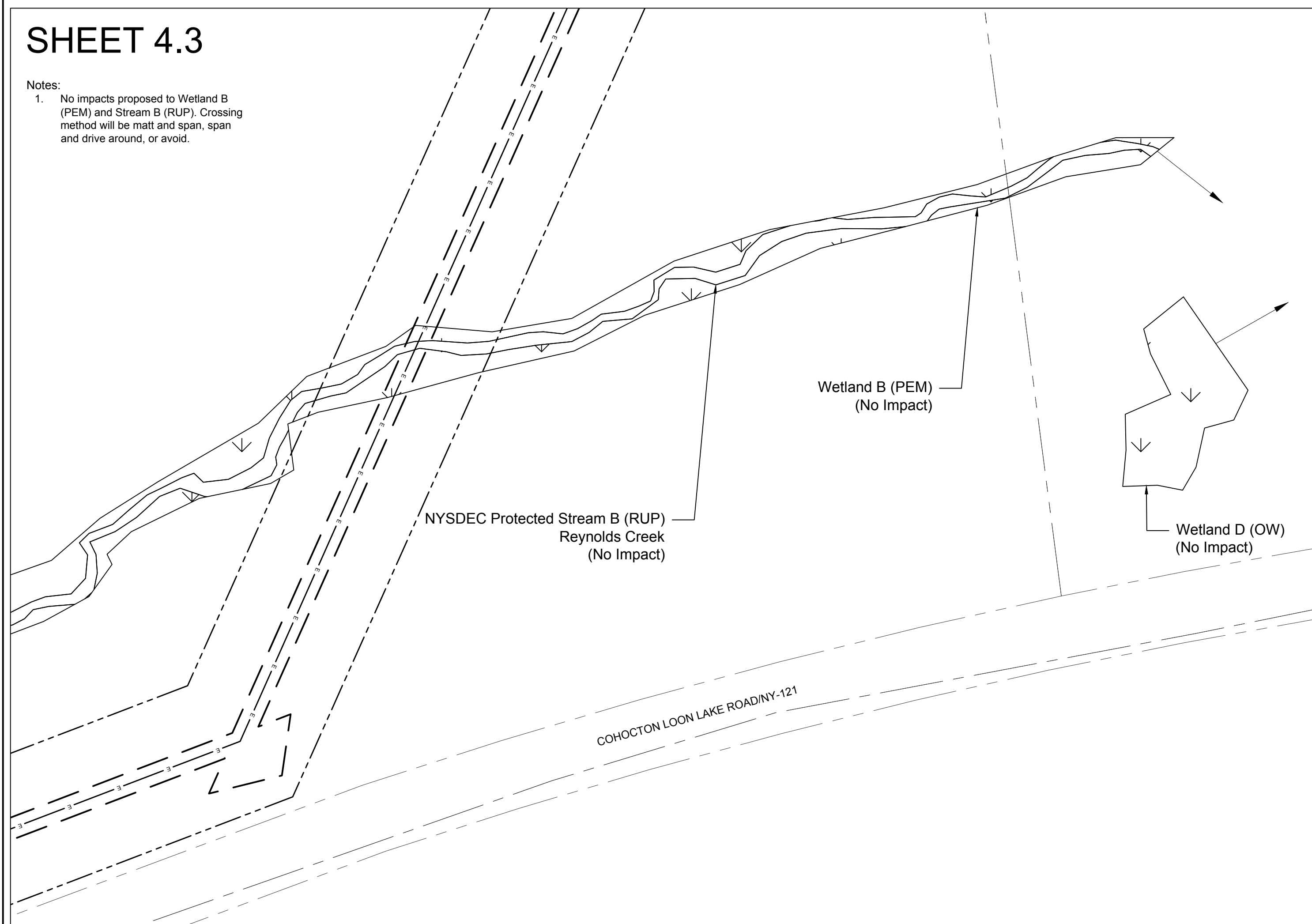

SHEET 4.4

Notes:
 1. No impacts proposed to Wetland B (PEM) and Stream B (RUP). Crossing method will be matt and span, span and drive around, or avoid.
 2. It is anticipated that a pole will be located within 50 feet of the top of the NYSDEC Protected Stream B bank.

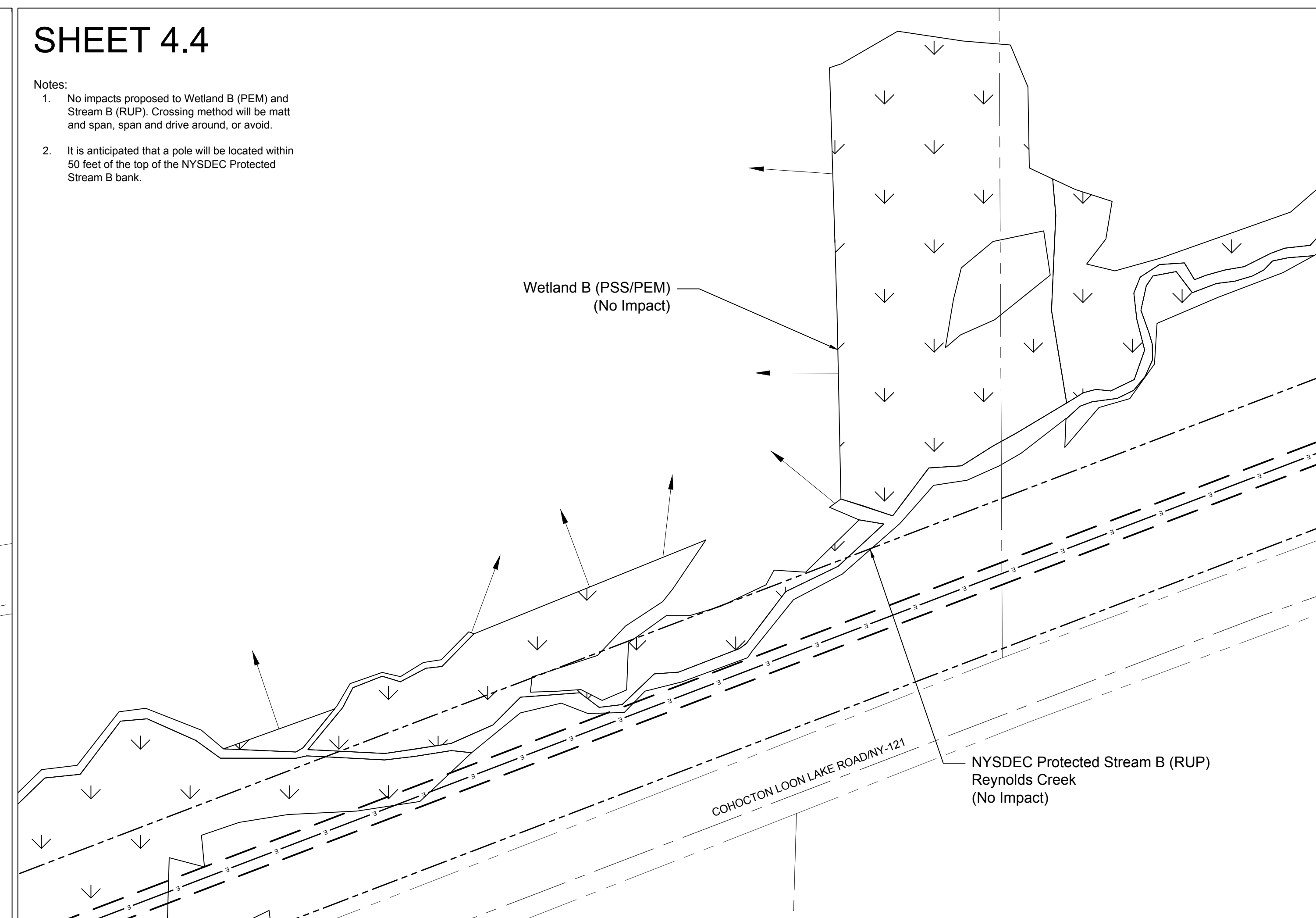

LEGEND

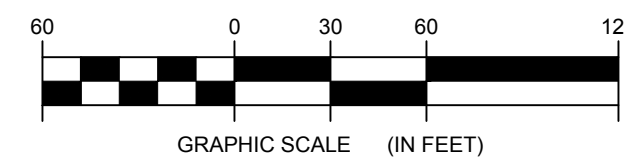

Environmental Design & Research,
 Landscape Architecture, Engineering
 & Environmental Services, D.P.C.

217 Montgomery Street, Suite 1000
 Syracuse, New York 13202
 P. 315.471.0688



everpower

©2010 Environmental Design & Research, Landscape Architecture, Engineering, and Environmental Services, D.P.C. The following is prepared for the use of the client only. It is not to be used for any other purpose without the written consent of Environmental Design & Research, Landscape Architecture, Engineering, and Environmental Services, D.P.C. The client acknowledges that it is responsible for the accuracy and completeness of the information provided to the consultant. The consultant is not responsible for the accuracy and completeness of the information provided to the client. The consultant is not responsible for the accuracy and completeness of the information provided to the client.

DRAWING REVISIONS	
NO.	DATE

PROJECT TITLE: BARON WINDS PROJECT
PROJECT LOCATION: TOWNS OF COHOCTON, DANVILLE, FRENCHTON, AND WAYLAND - STEUBEN COUNTY, NEW YORK
CLIENT: EVERPOWER WIND HOLDINGS
DRAWING TITLE: AREA 4 WETLAND/STREAM IMPACT OVERVIEW

DATE: NOVEMBER 17, 2017
SCALE: 1"=60'
ISSUE NO.: 13039
DRAWN BY: AW, JT, TS, PR
FILE NAME: 13039_Impacts_Area 4.dwg
DRAWING NUMBER: 4.1-4.4

J:\13039 Baron Winds and Project\Architectural\Impacts\Area 4.dwg

SHEET 4.5

- Notes:
- No impacts proposed to Wetland B (PEM) and Stream B (RUP). Crossing method will be matt and span, span and drive around, or avoid.
 - Based on preliminary design and evaluation, it is anticipated two poles will be located within Wetland B. Permanent impact due to pole installation is anticipated to be less than 20 sqft per pole.

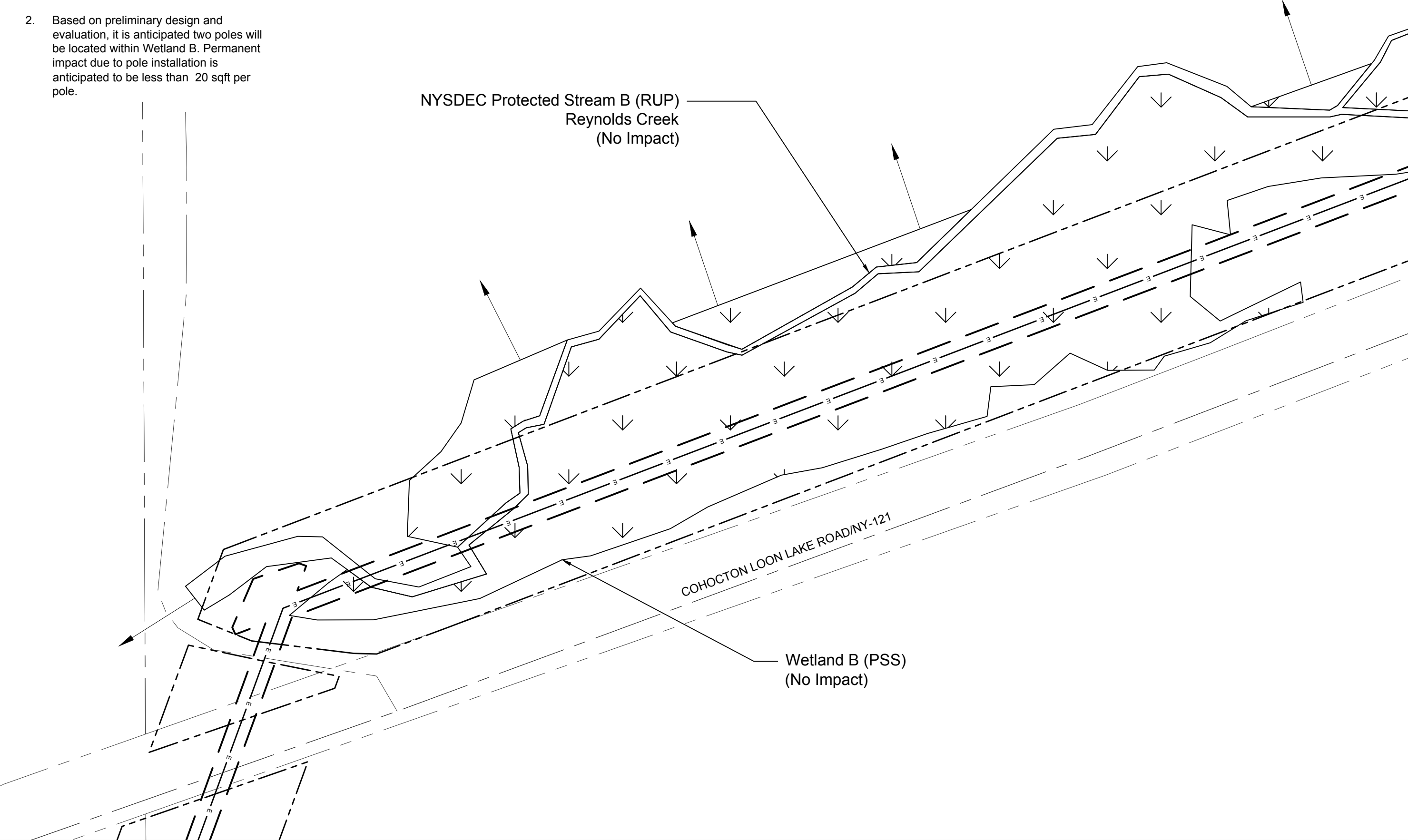

SHEET 4.6

- Notes:
- No impacts proposed to Stream 4A (RIN). Crossing method will be matt and span, span and drive around, or avoid.

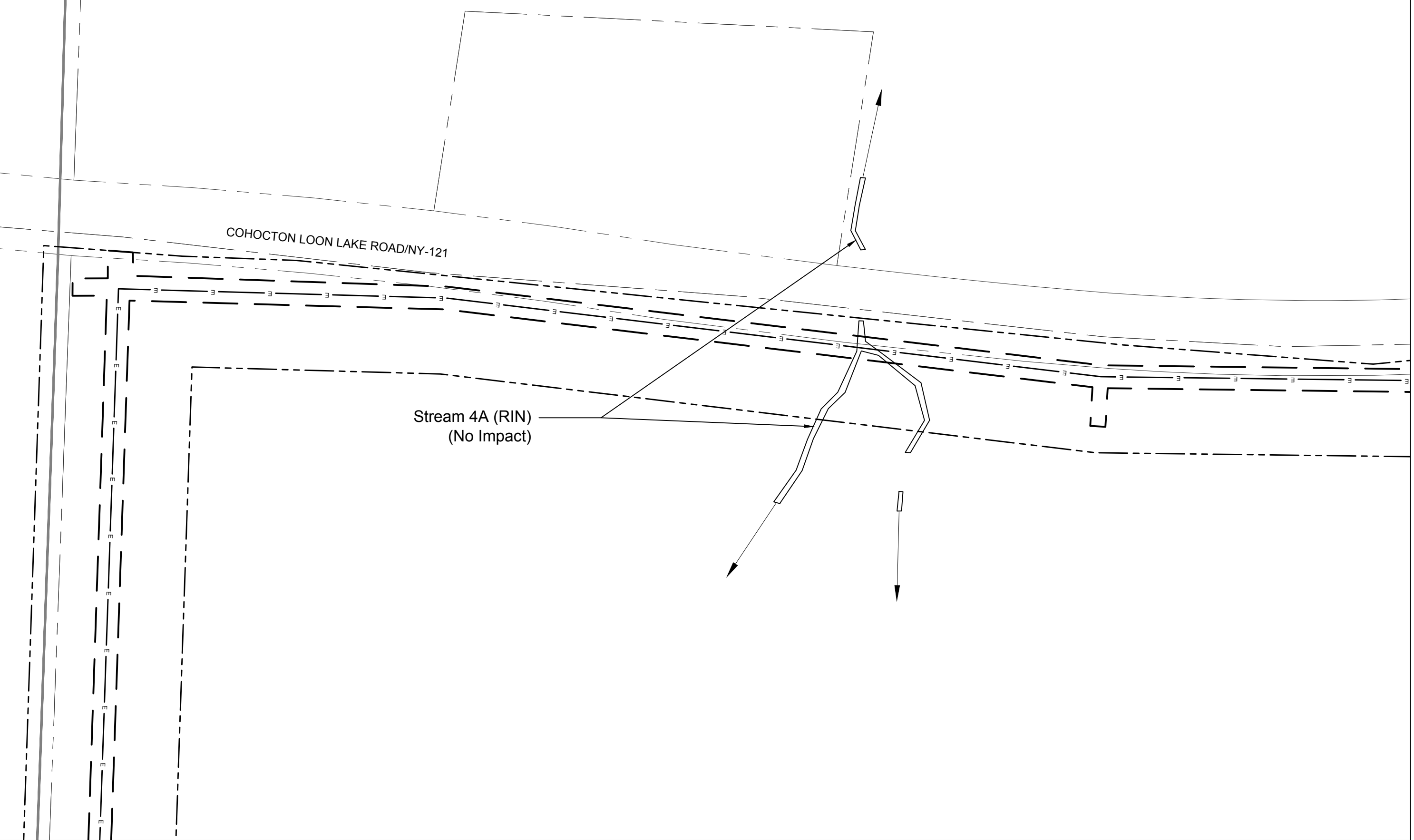

LEGEND

	Underground Collection Line		Limits of Grading		Limits of Vegetation Clearing
	Overhead Collection Line		Limits of Soil Disturbance		Wetland/Stream Continues

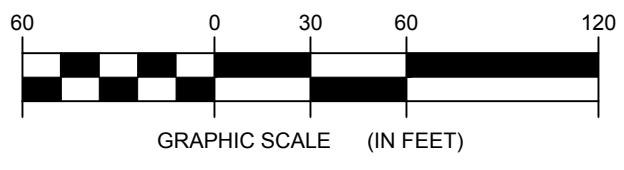

Environmental Design & Research,
Landscape Architecture, Engineering & Environmental Services, D.P.C.
217 Montgomery Street, Suite 1000
Syracuse, New York 13202
P. 315.471.0688



everpower

©2018 Environmental Design & Research, Landscape Architecture, Engineering & Environmental Services, D.P.C. The following is prepared for the use of the Client only. It is not to be used for any other purpose. This is a preliminary drawing and is subject to change without notice. The Client acknowledges that the use of this drawing for any other purpose is at their own risk. The Client shall be responsible for obtaining all necessary permits and approvals. The Client shall be responsible for obtaining all necessary insurance. The Client shall be responsible for obtaining all necessary approvals. The Client shall be responsible for obtaining all necessary approvals.

DRAWING REVISIONS	
NO.	REVISION

PROJECT TITLE: BARON WINDS PROJECT
PROJECT LOCATION: TOWNS OF COHOCTON, DANSVILLE, FREMONT, AND WAYLAND - STEUBEN COUNTY, NEW YORK
CLIENT: EVERPOWER WIND HOLDINGS
DRAWING TITLE: AREA 4 WETLAND/STREAM IMPACT OVERVIEW

DATE: NOVEMBER 17, 2017
SCALE: 1"=60'
ISSUE NO.: 13039
DRAWN BY: AW, JT, TS, PR
FILE NAME: 13039_Impacts_Area 4.dwg
DRAWING NUMBER: 4.5-4.6

J:\13039 Baron Wind Project\GIS\GIS\Impacts\Area 4.dwg